



Clifton,
Banbury, Oxfordshire

Clifton, Banbury, Oxfordshire.

Enviably situated at the end of a cul-de-sac, this versatile four bedroom detached home sits on its own corner plot with a double garage and off-road parking.

Clifton is a charming hamlet just east of Deddington in Oxfordshire, offering an attractive blend of rural tranquillity and accessibility. Set on the banks of the River Cherwell and surrounded by picturesque countryside, the village provides a peaceful, scenic environment with abundant wildlife and walking routes, including easy access to the Oxford Canal towpath.

Despite its idyllic setting, Clifton is conveniently located on the B4031, with good connections to Banbury, Bicester and the M40, as well as nearby rail links, making it ideal for commuters seeking a countryside lifestyle. The village itself has a public house, The Duke, while The Great Western Arms at nearby Aynho Wharf is just up the road; wider amenities, schools and shops in Deddington are also only a short distance away.

Overall, Clifton offers a rare combination of rural charm, heritage character and practical connectivity, making it a desirable location for both families and professionals.





The Property Briefly Comprises of:

- Detached Residence

Ground Floor

- Entrance Hall
- Cloakroom
- Kitchen/Breakfast Room
- Dining Room
- Sitting Room
- Study
- Double Bedroom with En-Suite

First Floor

- Three Bedrooms
- Family Bathroom

Outside

- Own Driveway
- Enclosed Rear Garden



Guide Price: £750,000

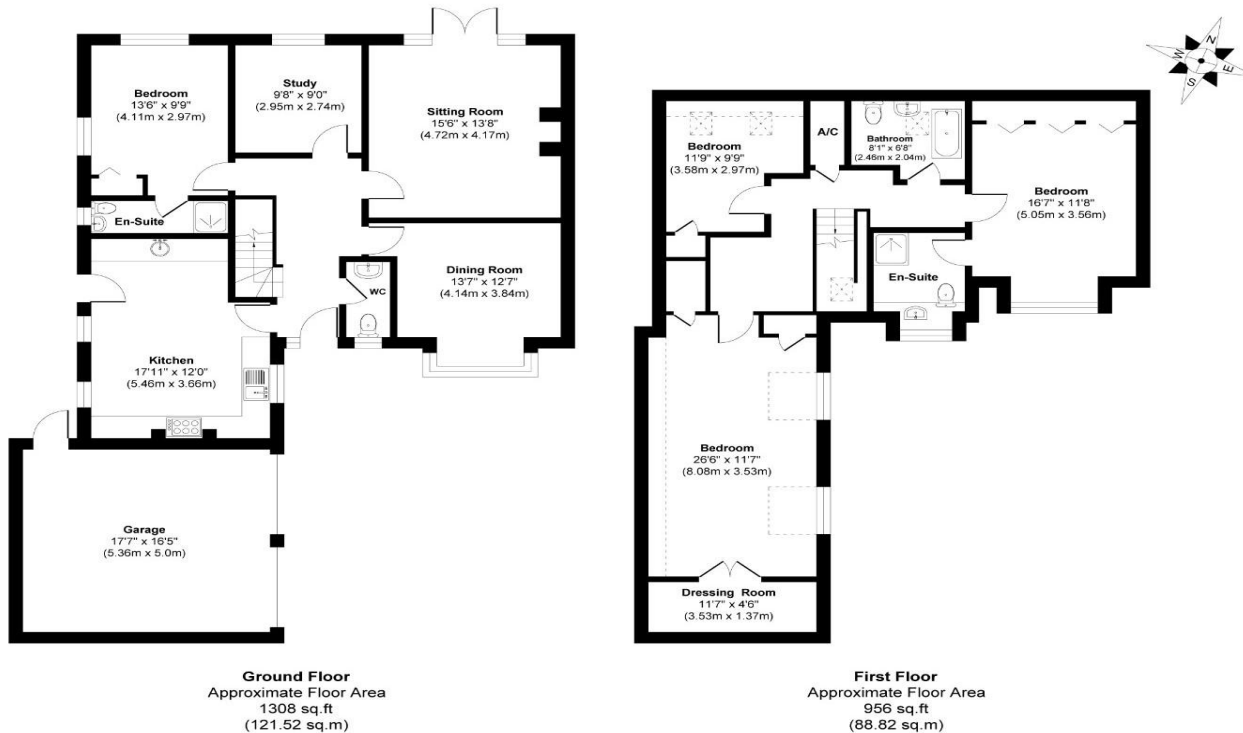

Illustration for identification purpose only, measurements are approximate, not to scale.

Local Authority: Cherwell

Council Tax Band: F

(Subject to change after completion)

Tenure: Freehold

Distances

- Banbury c. 7 miles
- Bicester c. 10 miles
- Chipping Norton c. 12 miles
- Oxford c. 19 miles
- Birmingham c. 59 miles
- London c. 72 miles
- M40 Access c. 6 miles
- London via Bicester c. 43 minutes

Buyers Purchase Fee:

Please note that buyers are required to pay a Purchase Fee of £300 (inc. of VAT) to Mark David on offer acceptance, to process a new transaction.

Mark David
ESTATE AGENTS
Sales • Lettings • Management

Market House, Market Place, Deddington, Oxfordshire
OX15 0SB
Tel: 01869 338898
Email: deddington@mark-david.co.uk
www.mark-david.co.uk

Important Notice

Mark David Estate Agents for themselves and their clients give notice that:-

1. They are not authorised to make or give representation or warranty in relation to this property, either on their own behalf or on behalf of the Seller. They assume no responsibility for any statement made in these particulars. These particulars do not form part of any offer or contract and must not be relied upon as statements or representations of fact.
2. Whilst every attempt has been made to ensure the accuracy of the floorplan contained here, measurements of doors, windows, rooms and any other items are approximate and no responsibility is taken for any error, omission, or mis-statement.
3. All areas, measurements or distances are approximate. The particulars are intended for guidance only and are not necessarily comprehensive. A wide angle lens may have been used in photography. Mark David Estate Agents have not tested appliances or services and it should not be assumed that the property has all necessary planning, building regulation and other consents. Buyers must satisfy themselves with the property by inspection or otherwise.
4. Reference to any mechanical or electrical equipment does not constitute a representation that such equipment is capable of fulfilling its function and prospective Buyers must make their own enquiries.
5. They have no responsibility for any expenses or costs incurred by prospective Buyers in inspecting properties which have been sold, let or withdrawn. Applicants are advised to contact the Agent to check availability and any other information of particular importance to them, prior to inspecting the property, particularly if traveling some distance.

