



Cropredy,
Banbury, Oxfordshire

Cropredy, Banbury, Oxfordshire.

A well positioned three double bedroom detached house in a generous plot in the centre of the pretty rural village of Cropredy. Would benefit from modernisation but gives an excellent opportunity to create a lovely family home in a sought after location.

The village's history is clear to see in the large number of remaining ironstone cottages and houses in the village. It is a lively, well served village with a good range of amenities including: Two Pubs, two Cafes, Shop, Post Office, Doctors Surgery and Dispensary, active Village Hall, Primary School, Church, and Chapel, and has a good array of sports clubs; Cricket, Football, Tennis, Canoe, and Judo.

Cropredy is some 4 miles north of Banbury, the nearest town, where a wide range of amenities can be found including supermarkets (M&S, Waitrose, Sainsburys, Tesco, Morrisons, Lidl and Aldi), shopping, restaurants, and cafes, ten pin bowling, sports centre, gyms, and cinemas. For commuters, Banbury has rail links to London, Oxford, Bicester, and Banbury and is on J11 of the M40 motorway.





The Property Briefly Comprises of:

- Detached Residence
- Entrance Hall
- Cloakroom
- Kitchen/Dining Room
- Pantry
- Store Utility
- Sitting Room
- Conservatory
- Three Double Bedrooms
- Family Bathroom
- Enclosed Rear Garden
- Own Driveway
- Single Garage
- Double Garage
- No Onward Chain



Guide Price: £500,000



Claydon Road, Cropredy
 Approximate Gross Internal Area
 Main House = 151.06 sq.m / 1626 sq.ft
 Garage = 40.32 sq.m / 434 sq.ft
Total = 191.38 sq.m / 2060 sq.ft

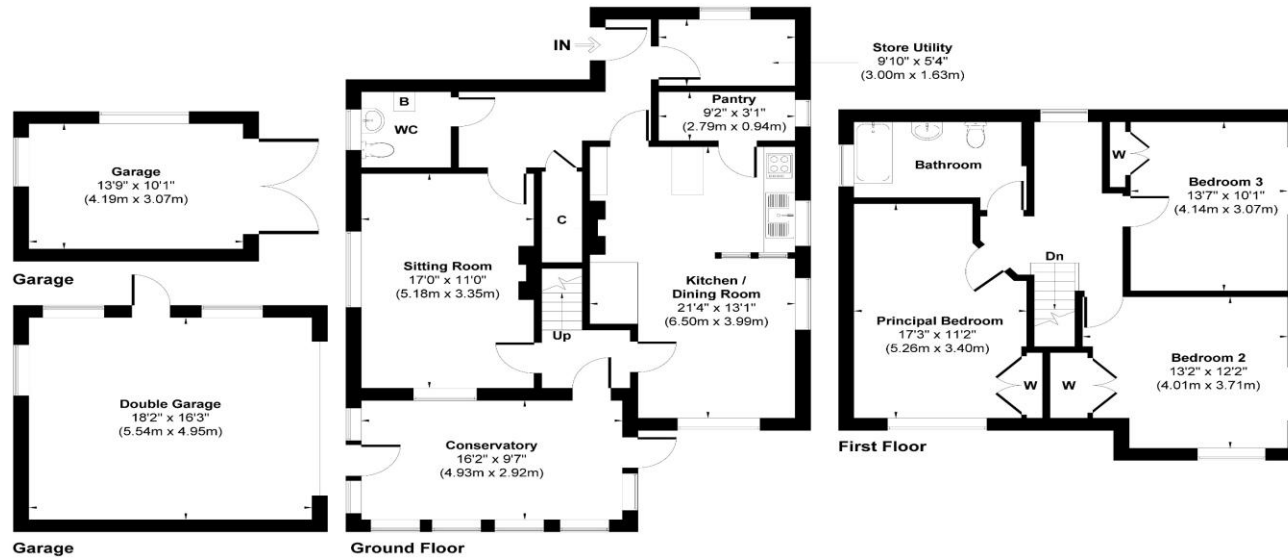

Illustration for identification purpose only, measurements approximate and not to scale.

Local Authority: Cherwell District Council

Council Tax Band: E

(Subject to change after completion)

Tenure: Freehold

Distances

- Banbury c. 6 miles
- Bicester c. 22 miles
- Stratford Upon Avon c. 32 miles
- Oxford c. 35 miles
- Birmingham c. 46 miles
- London c. 83 miles
- M40 Access c. 6 miles
- London via Bicester c. 43 minutes

Buyers Purchase Fee:

Please note that buyers are required to pay a Purchase Fee of £300 (inc. of VAT) to Mark David on offer acceptance, to process a new transaction.

Mark David
 ESTATE AGENTS
 Sales • Lettings • Management

Market House, Market Place, Deddington, Oxfordshire
 OX15 0SB
 Tel: 01869 338898
 Email: deddington@mark-david.co.uk
www.mark-david.co.uk



Important Notice

Mark David Estate Agents for themselves and their clients give notice that:-

1. They are not authorised to make or give representation or warranty in relation to this property, either on their own behalf or on behalf of the Seller. They assume no responsibility for any statement made in these particulars. These particulars do not form part of any offer or contract and must not be relied upon as statements or representations of fact.
2. Whilst every attempt has been made to ensure the accuracy of the floorplan contained here, measurements of doors, windows, rooms and any other items are approximate and no responsibility is taken for any error, omission, or mis-statement.
3. All areas, measurements or distances are approximate. The particulars are intended for guidance only and are not necessarily comprehensive. A wide angle lens may have been used in photography. Mark David Estate Agents have not tested appliances or services and it should not be assumed that the property has all necessary planning, building regulation and other consents. Buyers must satisfy themselves with the property by inspection or otherwise.
4. Reference to any mechanical or electrical equipment does not constitute a representation that such equipment is capable of fulfilling its function and prospective Buyers must make their own enquiries.
5. They have no responsibility for any expenses or costs incurred by prospective Buyers in inspecting properties which have been sold, let or withdrawn. Applicants are advised to contact the Agent to check availability and any other information of particular importance to them, prior to inspecting the property, particularly if traveling some distance.