



Adderbury,  
Banbury, Oxfordshire



## Adderbury, Banbury, Oxfordshire

---

A sublime, detached home in an idyllic position, with a charming rear garden, detached garage, and private parking.

The picturesque village of Adderbury is a well-known Oxfordshire location celebrated for its blend of historic charm and modern convenience.

Families are particularly drawn to this area due to its excellent local schooling options, including a well-regarded primary school within the village and the Warriner School in nearby Bloxham.

In addition, the train stations in close-by Banbury, King's Sutton, and Bicester provide regular services to London, with journey times of approximately one hour.







## The Property Briefly Comprises of:

- Detached Cottage
- Entrance Hall
- Sitting Room with Log Burning Fire
- Dining Room with Log Burning Fire
- Modern Kitchen
- Conservatory
- Cellar
- Dual Aspect Master Bedroom
- Dressing Room
- Shower Room
- Further Double Bedroom
- Family Bathroom
- Charming Rear Garden
- Garage
- Off Street Parking



Guide Price: £750,000



Approximate Gross Internal Area = 156.3 sq m / 1682 sq ft  
 Cellar = 7.9 sq m / 85 sq ft  
 Garage = 16.2 sq m / 174 sq ft  
 Store = 3.0 sq m / 32 sq ft  
 Total = 183.4 sq m / 1973 sq ft

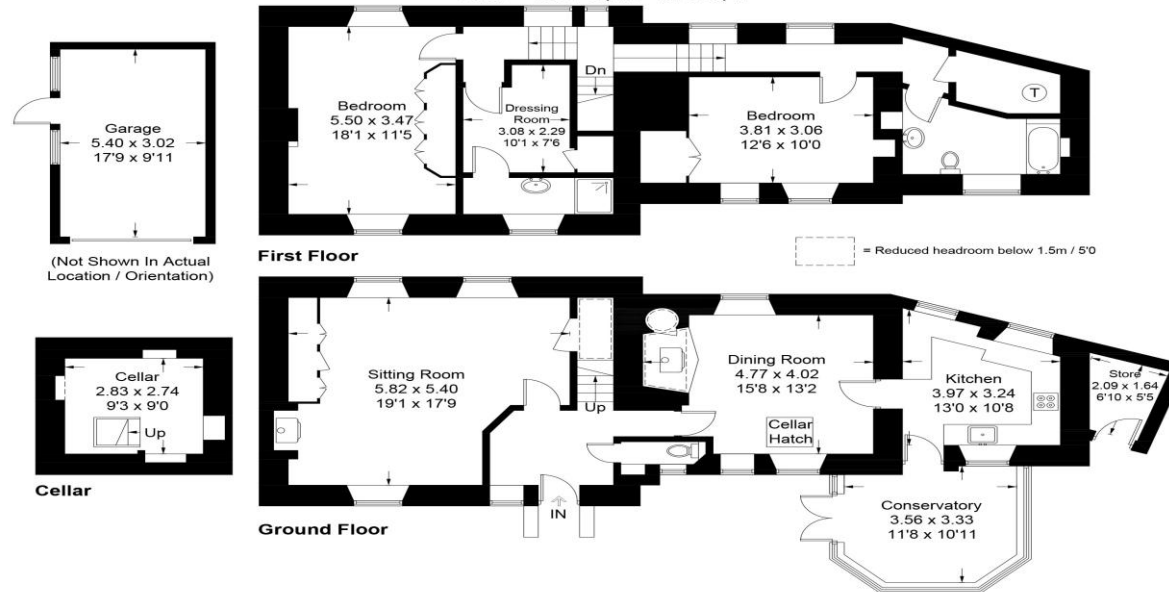

Illustration for identification purposes only, measurements are approximate, not to scale. Fourlabs.co © (ID1171684)

**Local Authority:**  
 Cherwell District Council

**Council Tax Band:** F

(Subject to change after completion)

**Tenure:** Freehold

### Distances

Deddington c. 3 miles  
 Banbury c. 4 miles  
 Chipping Norton c. 13 miles  
 Oxford c. 21 miles  
 Birmingham c. 55 miles  
 London c. 74 miles  
 M40 Access c. 5 Miles  
 London via Bicester c. 43 minutes

**Mark David**  
 ESTATE AGENTS  
 Sales • Lettings • Management

Market House, Market Place, Deddington, Oxfordshire  
 OX15 0SB  
 Tel: 01869 338898  
 Email: [deddington@mark-david.co.uk](mailto:deddington@mark-david.co.uk)  
[www.mark-david.co.uk](http://www.mark-david.co.uk)

### Important Notice

Mark David Estate Agents for themselves and their clients give notice that:-

1. They are not authorised to make or give representation or warranty in relation to this property, either on their own behalf or on behalf of the Seller. They assume no responsibility for any statement made in these particulars. These particulars do not form part of any offer or contract and must not be relied upon as statements or representations of fact.
2. Whilst every attempt has been made to ensure the accuracy of the floorplan contained here, measurements of doors, windows, rooms and any other items are approximate and no responsibility is taken for any error, omission, or mis-statement.
3. All areas, measurements or distances are approximate. The particulars are intended for guidance only and are not necessarily comprehensive. A wide angle lens may have been used in photography. Mark David Estate Agents have not tested appliances or services and it should not be assumed that the property has all necessary planning, building regulation and other consents. Buyers must satisfy themselves with the property by inspection or otherwise.
4. Reference to any mechanical or electrical equipment does not constitute a representation that such equipment is capable of fulfilling its function and prospective Buyers must make their own enquiries.
5. They have no responsibility for any expenses or costs incurred by prospective Buyers in inspecting properties which have been sold, let or withdrawn. Applicants are advised to contact the Agent to check availability and any other information of particular importance to them, prior to inspecting the property, particularly if traveling some distance.

