



Chipping Norton,  
Oxfordshire

## Chipping Norton, Oxfordshire.

A modern two bedroom mid terrace house with no onward chain, situated within a short walk to the town centre, on a quiet cul-de-sac with attractive rear garden, two parking spaces and en-suite to main bedroom.

Chipping Norton is widely admired as the gateway to the Cotswolds. The charismatic and historical market town centre has a marvellous range of individual shops, boutiques, cafes, public houses, hotels as well as retail, commercial and leisure facilities. Chipping Norton also benefits from a Town Hall, Theatre and Health Centre including two surgeries, pharmacy and maternity unit, all within close proximity to the town centre.

Local amenities include Sainsbury's, a large Midcounties Cooperative, an Aldi supermarket and a Marks and Spencer food hall. There are nurseries, primary schools, a secondary school and numerous churches nearby. Fabulous Cotswold countryside is within easy reach, offering magnificent scenery for walking and riding.

Just a short drive away, there is so much to discover, drink, dine, shop and relax at Daylesford Organic farm shop (6.5 miles) and Soho Farmhouse is a rural escape offering food and drinks, wellness experiences and outdoor activities (7.5 miles).





## The Property Briefly Comprises of:

- Mid Terrace Property
- Short Walk To Town Centre
- Entrance Hall
- Sitting Room
- Kitchen
- Two Bedrooms
- En-Suite Shower Room
- Bathroom
- Rear Garden
- Two Allocated Parking Spaces
- No Onward Chain



Guide Price: £275,000



**12 Cotshill Gardens, Chipping Norton, OX7 5AA**  
 Total Approx. Gross Area:- 55.16 sq.m. 594 sq.ft.

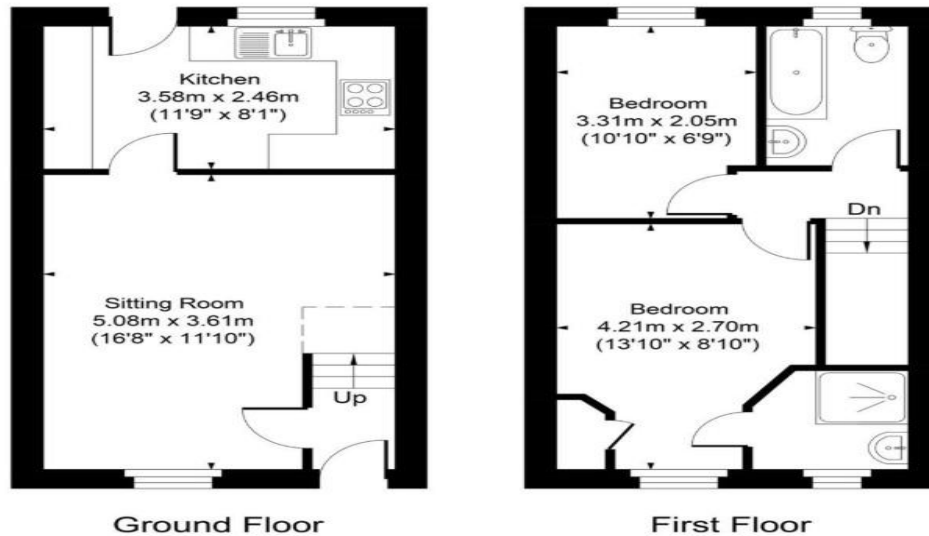

FOR ILLUSTRATIVE PURPOSES ONLY-NOT TO SCALE  
 The position & size of doors, windows, appliances and other features are approximate only.  
 □ □ Denotes restricted head height  
 www.dmlphotography.co.uk

**Local Authority:**  
 West Oxfordshire District Council

**Council Tax Band: C**  
 (Subject to change after completion)

**Tenure: Freehold**

**Distances**  
 Kingham c. 5 miles  
 Charlbury c. 6 miles  
 Soho Farmhouse c. 7.5 miles  
 Banbury c. 13 miles  
 Oxford c. 20 miles  
 Cheltenham c. 28 miles  
 Swindon c. 31 miles  
 Birmingham c. 56 miles  
 London c. 74 miles  
 Charlbury or Kingham to London, c. 1 hour  
 Oxford to London Paddington c. 1 hour

**Buyers Purchase Fee:**  
 Please note that buyers are required to pay a Purchase Fee of £300 (inc. of VAT) to Mark David on offer acceptance, to process a new transaction.

**Mark David**  
 ESTATE AGENTS  
 Sales • Lettings • Management

9 Market Place, Chipping Norton Oxfordshire  
 OX7 5NA  
 Tel: 01608 644944  
 Email: [chippingnorton@mark-david.co.uk](mailto:chippingnorton@mark-david.co.uk)  
[www.mark-david.co.uk](http://www.mark-david.co.uk)

**Important Notice**

Mark David Estate Agents for themselves and their clients give notice that:-  
 1. They are not authorised to make or give representation or warranty in relation to this property, either on their own behalf or on behalf of the Seller. They assume no responsibility for any statement made in these particulars. These particulars do not form part of any offer or contract and must not be relied upon as statements or representations of fact.  
 2. Whilst every attempt has been made to ensure the accuracy of the floorplan contained here, measurements of doors, windows, rooms and any other items are approximate and no responsibility is taken for any error, omission, or mis-statement.  
 3. All areas, measurements or distances are approximate. The particulars are intended for guidance only and are not necessarily comprehensive. A wide angle lens may have been used in photography. Mark David Estate Agents have not tested appliances or services and it should not be assumed that the property has all necessary planning, building regulation and other consents. Buyers must satisfy themselves with the property by inspection or otherwise.  
 4. Reference to any mechanical or electrical equipment does not constitute a representation that such equipment is capable of fulfilling its function and prospective Buyers must make their own enquiries.  
 5. They have no responsibility for any expenses or costs incurred by prospective Buyers in inspecting properties which have been sold, let or withdrawn. Applicants are advised to contact the Agent to check availability and any other information of particular importance to them, prior to inspecting the property, particularly if traveling some distance.

