



Croughton  
Northants

## Croughton, Northants.

A fabulous, detached bungalow, extending to nearly 1500 sq ft, on a superb, south facing plot of nearly half an acre. Peaceful, tucked away position within an easy walk of the nearby village amenities.

Croughton is located to the southwest of Brackley on the Northamptonshire/Oxfordshire borders. It has many fine period properties, and benefits from All saints Church, Puddleducks Nursery and pre-school, Croughton All Saints C.E Primary School, and Croughton Tea Rooms.

There is a strong community social scene with an annual Village and church fete, and a variety of clubs and activities such as baby & toddler groups, fitness classes, sewing & crafts, gardening, and WI, which are held at Croughton Village Hall.

More comprehensive facilities can be found in Brackley, Bicester and Banbury where there is the Castle Quay shopping centre and Spiceball leisure centre. The village has access to the A43 dual carriageway, which links the M40 and M1 motorways. There are main line railway stations at Banbury and Bicester (London Marylebone).





## The Property Briefly Comprises of:

- Kitchen/Dining Room
- Utility Room
- Sitting Room
- Master Bedroom with Ensuite
- Two Further Bedrooms
- Modern Family Bathroom
- Detached Workshop
- Garage and Parking
- South Facing Rear Garden, enclosed and backing onto open fields
- No Onward Chain
- Village Community



Guide Price: £695,000



## Applecross

Approximate Gross Internal Area = 149.4 sq m / 1608 sq ft (Including Garage)  
 Workshop = 62.8 sq m / 676 sq ft  
 Total = 212.2 sq m / 2284 sq ft

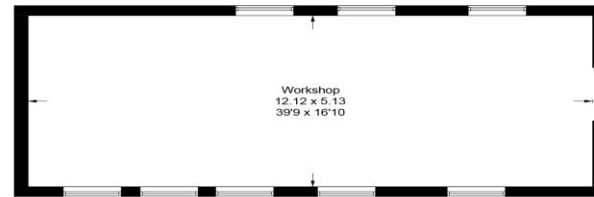

(Not Shown In Actual Location / Orientation)

Ground Floor

Illustration for identification purposes only, measurements are approximate, not to scale. Fourlabs.co © (ID1171259)

**Local Authority:**  
 South Northamptonshire

**Council Tax Band: F**

(Subject to change after completion)

**Tenure**

Freehold

**Distances**

Banbury c. 14 miles  
 Chipping Norton c. 17 miles  
 Bicester c. 11 miles  
 Oxford c. 24 miles  
 Birmingham c. 64 miles  
 London c. 73 miles  
 London via Bicester c. 43 minutes

**Mark David**  
 ESTATE AGENTS  
 Sales • Lettings • Management

Market House, Market Place, Deddington, Oxfordshire  
 OX15 0SB  
 Tel: 01869 338898  
 Email: [deddington@mark-david.co.uk](mailto:deddington@mark-david.co.uk)  
[www.mark-david.co.uk](http://www.mark-david.co.uk)



### Important Notice

Mark David Estate Agents for themselves and their clients give notice that:-

1. They are not authorised to make or give representation or warranty in relation to this property, either on their own behalf or on behalf of the Seller. They assume no responsibility for any statement made in these particulars. These particulars do not form part of any offer or contract and must not be relied upon as statements or representations of fact.
2. Whilst every attempt has been made to ensure the accuracy of the floorplan contained here, measurements of doors, windows, rooms and any other items are approximate and no responsibility is taken for any error, omission, or mis-statement.
3. All areas, measurements or distances are approximate. The particulars are intended for guidance only and are not necessarily comprehensive. A wide angle lens may have been used in photography. Mark David Estate Agents have not tested appliances or services and it should not be assumed that the property has all necessary planning, building regulation and other consents. Buyers must satisfy themselves with the property by inspection or otherwise.
4. Reference to any mechanical or electrical equipment does not constitute a representation that such equipment is capable of fulfilling its function and prospective Buyers must make their own enquiries.
5. They have no responsibility for any expenses or costs incurred by prospective Buyers in inspecting properties which have been sold, let or withdrawn. Applicants are advised to contact the Agent to check availability and any other information of particular importance to them, prior to inspecting the property, particularly if traveling some distance.