



Middle Barton,
Chipping Norton, Oxfordshire

Middle Barton, Chipping Norton, Oxfordshire.

A versatile detached residence offering flexible living space suited to a range of family needs.

Middle Barton is a popular village with easy access to Deddington, Banbury, Bicester, Chipping Norton, and Oxford. There is a Village Primary School, Village Stores, Post Office, Lebanese Restaurant, Active Sports and Social Club with a Playground and a Public House.

A community bus service, Our Bus Bartons, operates services to Banbury, Oxford and surrounding villages and provides a link to local health centres, supermarkets and railway stations.

Approximately 4 miles away in the beautiful village of Great Tew you will find Soho Farmhouse, a luxury private members' club set in 100 acres of Oxfordshire countryside, offering food and drink, bedrooms, a pool, spa and gym.





The Property Briefly Comprises of:

- Detached Residence

Ground Floor

- Entrance Hall
- Kitchen/Breakfast Room
- Sitting Room
- Garden Room
- Utility
- Two Double Bedrooms
- Two Ground Floor Shower Rooms

First Floor

- Two Double Bedrooms
- Shower Room
- Two Further Single Bedrooms/Office Space/Playroom/Storage.

Outside

- Own Driveway
- Enclosed Low Maintenance Rear Garden

Guide Price: £650,000





Middle Barton, Chipping, Norton, Oxfordshire
 Approximate Gross Internal Area = 203.09 sq.m / 2186 sq.ft

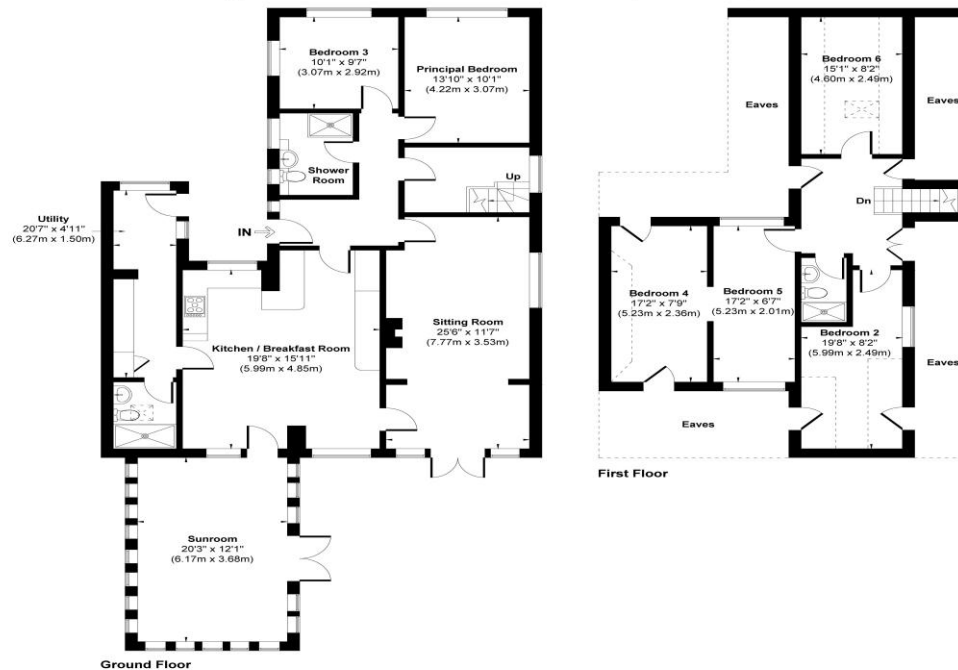

Illustration for identification purpose only, measurements approximate and not to scale.

Local Authority: West Oxfordshire

Council Tax Band: E

(Subject to change after completion)

Tenure: Freehold

Distances

- Deddington c. 6 miles
- Chipping Norton c. 8 miles
- Bicester c. 10 miles
- Banbury c. 12 miles
- Oxford c. 16 miles
- London Marylebone via Oxford, c. 1 hour

Buyers Purchase Fee:

Please note that buyers are required to pay a Purchase Fee of £300 (inc. of VAT) to Mark David on offer acceptance, to process a new transaction.

Mark David
 ESTATE AGENTS
 Sales • Lettings • Management

Market House, Market Place, Deddington, Oxfordshire
 OX15 0SB
 Tel: 01869 338898
 Email: deddington@mark-david.co.uk
 www.mark-david.co.uk



Important Notice

Mark David Estate Agents for themselves and their clients give notice that:-
 1. They are not authorised to make or give representation or warranty in relation to this property, either on their own behalf or on behalf of the Seller. They assume no responsibility for any statement made in these particulars. These particulars do not form part of any offer or contract and must not be relied upon as statements or representations of fact.
 2. Whilst every attempt has been made to ensure the accuracy of the floorplan contained here, measurements of doors, windows, rooms and any other items are approximate and no responsibility is taken for any error, omission, or mis-statement.
 3. All areas, measurements or distances are approximate. The particulars are intended for guidance only and are not necessarily comprehensive. A wide angle lens may have been used in photography. Mark David Estate Agents have not tested appliances or services and it should not be assumed that the property has all necessary planning, building regulation and other consents. Buyers must satisfy themselves with the property by inspection or otherwise.
 4. Reference to any mechanical or electrical equipment does not constitute a representation that such equipment is capable of fulfilling its function and prospective Buyers must make their own enquiries.
 5. They have no responsibility for any expenses or costs incurred by prospective Buyers in inspecting properties which have been sold, let or withdrawn. Applicants are advised to contact the Agent to check availability and any other information of particular importance to them, prior to inspecting the property, particularly if traveling some distance.